

Parallel coupling / Size : 90 x 90

Operating distance  
4...9mm

Remote Base  
shared dimension

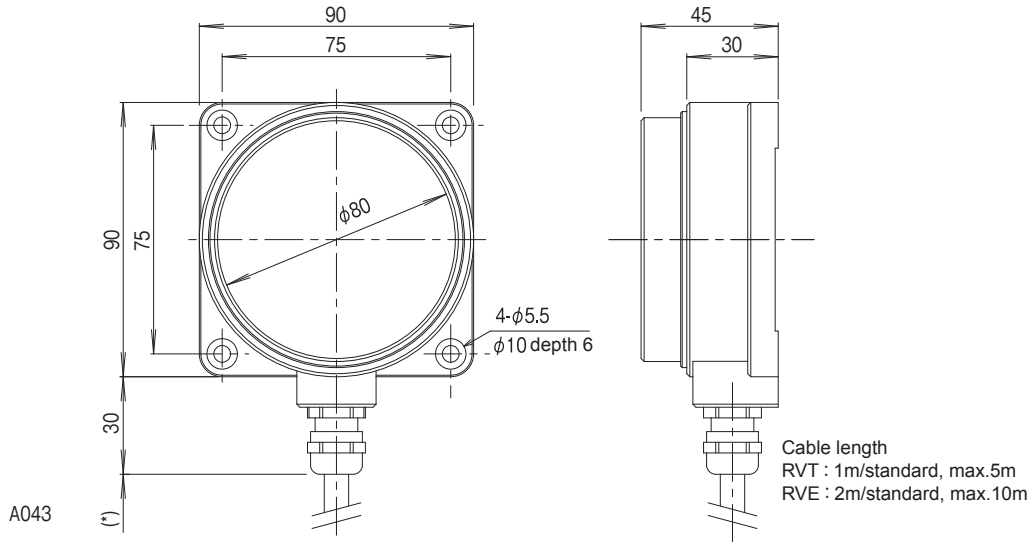

Wiring Brown:+ / Blue:-

Remote	
Type Code	<b>RVT-211-22-PU-01</b>
Drive voltage	24V ± 1.5V DC
Drive current	≤ 2A
Operating distance	4...9mm    6...8mm
Center offset	±5mm    ±3mm
Drive current	≤ 1A    ≤ 2A
Operating temperature	0...+50°C
Protection class	IP67
Cable	PUR / Ø7.8, 2x1.25mm <sup>2</sup> +2x0.2mm <sup>2</sup> with shield
Material Housing	Aluminum + alumite processing (metal part)
Active face	ABS+PBT (resin part)
Weight	Body 600 g + Cable 120 g × 1 m
Remark	2 (Black,White:0.2mm <sup>2</sup> ) of the 4 conductor is not used.

Base	
Type Code	<b>RVE-211-2-PU-02</b>
Supply voltage	24V DC ±5% (including ripple)
Current consumption	≤ 4A
Load current	---
Frequency of operation	---
LED	---
Operating temperature	0...+50°C
Protection class	IP67
Cable	PUR / Ø7.8, 2x1.25mm <sup>2</sup> +2x0.2mm <sup>2</sup> with shield
Material Housing	Aluminum + alumite processing (metal part)
Active face	ABS+PBT (resin part)
Weight	Body 620 g + Cable 120 g × 2 m
Remark	2 (Black,White:0.2mm <sup>2</sup> ) of the 4 conductor is not used.

### Applicable sensor and actuator

Supply voltage	24V DC	The total of current consumption of all devices connected to Remote must not exceed 2A the drive current.
Total current consumption	≤ 2A	
Residual voltage	---	
Leakage current	---	

### Installation notes

In order to avoid influence of surrounding metal, or to avoid mutual influence between parallel-mounted sensors, keep the minimum free zone as described below.

- Surrounding metal
- Parallel installation

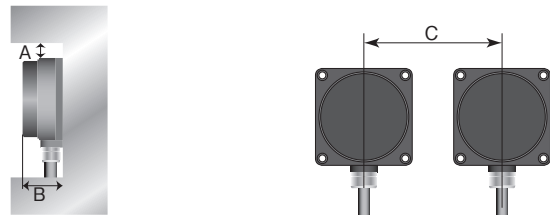

Type Code	A(mm)	B(mm)	C(mm)
RVT-211-22-PU-__	50	45	300
RVE-211-2-PU-__			

### Typical Transmitting Diagram (Supply voltage at 24V / non-flush mount)

RVT-211-22-PU-\_\_ / RVE-211-2-PU-\_\_

