

# Wireless Power Supply CC-Link Signal Transmission

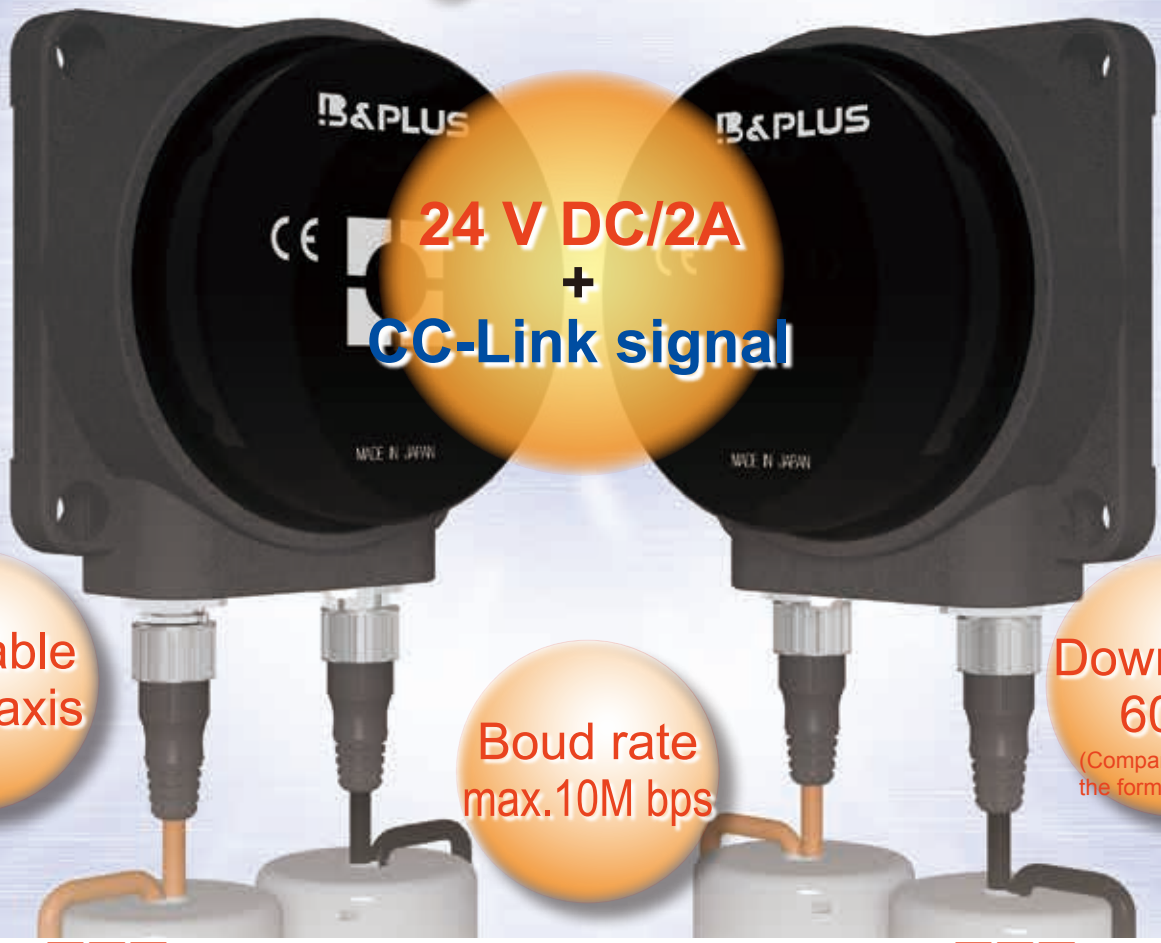

Rotatable  
on an axis

Boud rate  
max.10M bps

Downsized  
60 %  
(Comparison with  
the former product.)

■ □ ■ Movable CC-Link network is realized ■ □ ■

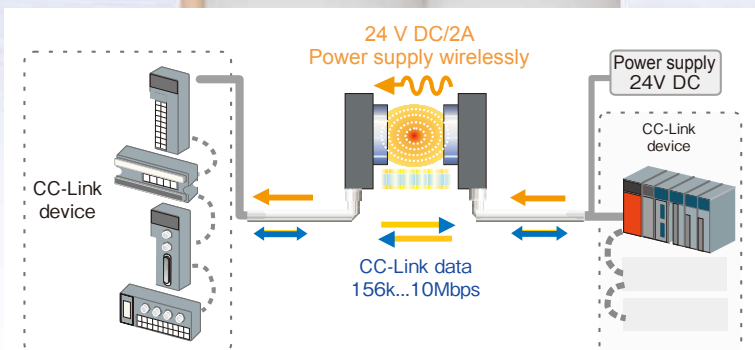

**CC-Link**

Wireless power supply and CC-Link data communication are possible by one unit of Remote coupler system/ CC-Link RCD22. RCD22 makes it possible to mount CC-Link devices on a rotating or moving equipment.

■ □ ■ Remote system expands possibility of Kaizen ! ■ □ ■

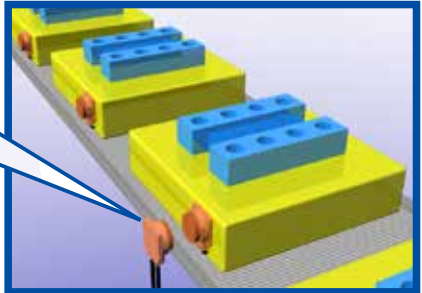

**At the transfer line**  
CC-Link communication is performed at the same time supplying a power to the pallet!  
↓  
Wiring-saving and work-saving  
- Connector-free and automation come true.  
- Work man-hours decrease

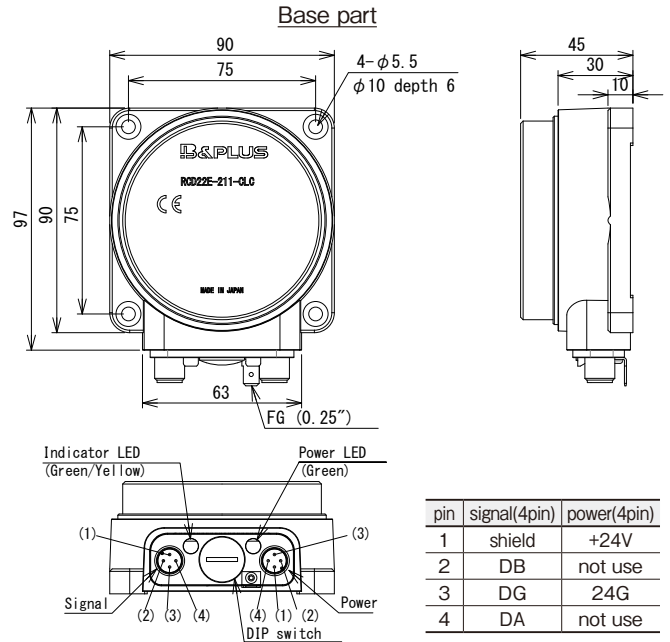
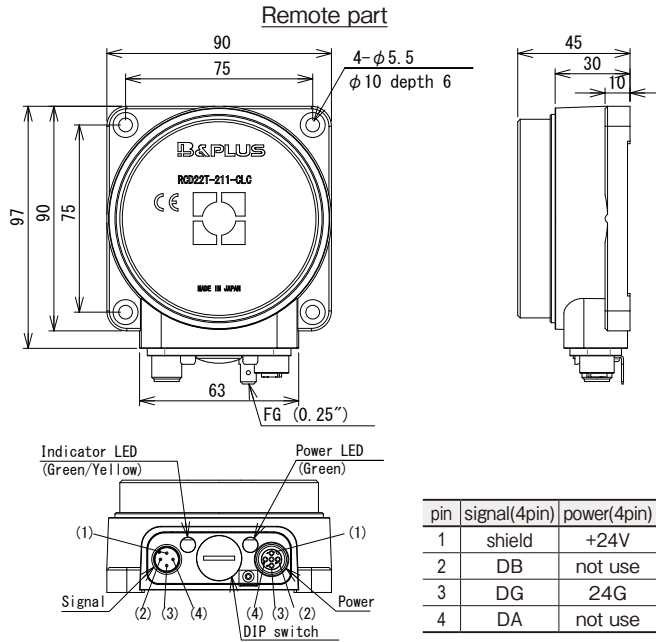
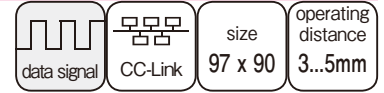

Type code	<b>RCD22T-211-CLC</b>
Drive voltage	24 V ± 1.5 V DC
Drive current	≤ 2A
Operating distance	3...5 mm
center offset	± 4 mm
Operating temperature	0...+50 deg. C.
Protection class	IP 67
Connector	Signal M12/4 pin Male (Available accessory : VA-4DSX ※ CCG4) Power M12/4 pin Female (Available accessory : TM-4DBX ※ HG2-1/3)
Material	Housing Aluminum anodized Active surface ABS + PBT
Weight	800 g
Included items	Ferrite core clamp (Gray x2, white x1)

Sold separately cable model during ※, the length of the cable(m) will contain. VA-4DSX ※ CCG4 = 2m or 5m or 10m, TM-4DBX ※ HG2-1/3 = 2m or 5m

Type code	<b>RCD22E-211-CLC</b>
Operating voltage	24 V DC ± 5 % (include ripple)
Current consumption	≤ 3 A
Communication	CC-Link データ signal
Baud rate	156K...10M bps (set by DIP switch)
Start-up	≤ 2 sec.*
Operating temperature	0...+50 deg. C.
Protection class	IP 67
Connector	Signal M12/4 pin Male (Available accessory : VA-4DSX ※ CCG4) Power M12/4 pin Male (Available accessory : TM-4DSX5HG2-1/3)
Material	Housing Aluminum anodized Active surface ABS + PBT
Weight	800 g
Included items	Ferrite core clamp (Gray x2, white x1)

\* The boot-time of RCD22. The start-up time of CC-Link varies with the system.

**Typical Transmitting Diagram (Supply voltage at 24V, non-flush mount)**

RCD22T-211-CLC / RCD22E-211-CLC

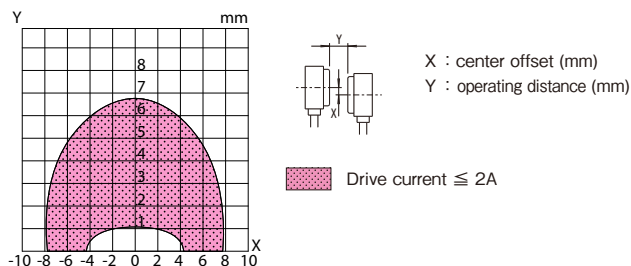

**Installation**

In order to avoid influence of surrounding metal and mutual interference, keep the minimum distance as described below.

**Surrounding Metal**

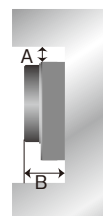

**Mutual interference**

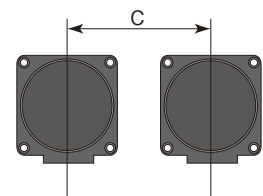

Type code	A(mm)	B(mm)	C(mm)
RCD22T-211-CLC	50	45	300
RCD22E-211-CLC			

**Notes**

- It is recommended to install RCD in metal in order to reduce the influence of self-heating.
- Be sure to connect a terminator between DA and DB on both ends on the CC-Link.
- The cable length must be decided considering the total length of the entire network.
- Connectors and cables are not included.
- Ground RCD22 with FG tab and fixing screws.

**B & PLUS K.K.**

274 Gomyo Tokigawa-machi  
Hiki-gun Saitama 355-0343 Japan  
E-mail : b-plus@b-plus-kk.jp

<http://www.b-plus-kk.jp>

**USA Branch**

3940 Olympic Blvd. Suite 400  
Erlanger, KY 41018  
E-mail : b-plus-usa@b-plus-kk.com

<http://www.b-plus-kk.com>

\*Specification is subject to change without notice.